

42 76 48

WRITTEN BY:	R A Leppala
CHECKED BY:	G E Meyer
APPROVED BY:	J L Regehr
FIELD SUPPORT/DP CE REVIEW:	C A Lopez

TITLE: SYSTEM/5363 HIGH DENSITY TAPE (2675) FEATURE UPGRADE

BEFORE INSTALLATION (Steps 1-8)

1.0 MACHINES AFFECTED

System/5363 all models.

2.0 PREREQUISITES/CONCURRENT/COMPANION

2.1 PREREQUISITES

Customer must have IOP feature upgrade (FC 2601) and Release 5.1 microcode, SSP.

2.2 CONCURRENT (MUST BE INSTALLED TOGETHER)

2.2.1 5727-SS6 Feature 6144 S/36 Tape Support for 5363 with current level PTFs.

Note: Tape drive cannot operate or be tested until this software is installed. Installation is a customer responsibility.

2.2.2 Microcode diskettes 61 and 62, PN 6374384 and 6374385.

2.2.3 If the low density tape is presently installed, the new tape drive, tape attach card, and signal cable replace the existing ones.

2.2.4 Release 5.1 Program Temporary Fixes
PTF 52416.

To verify that this PTF is installed, execute the following procedure: 'DUMP PTF,CRT'.

Several screens of PTFs will be displayed. If this PTF is listed by any of the modules on the screens, then no further action is required. If this PTF is

EC NO	837452A	837452B						
DATE	18OCT88	09DEC88						

NOT listed on any of the screens, then the special diskette labeled LOAD2675 (included with this MES) must be installed. To install:

1. Insert the diskette labeled "LOAD2675", PN 6374387, into your diskette drive.
2. At the main help menu, type TOLIBR LOAD2675,,,REPLACE,#LIBRARY and press the Enter key.
3. When the main help menu reappears, type LOAD2675 and press the Enter key.
4. Select Option 0 if this message appears "Sys-2563 #ONLPD--Extent being created for this library".

Note: Dump PTF, CRT procedure will not show PTF 52416 if TOLIBR 2657 procedure is used.

2.3 COMPANION (MAY BE INSTALLED SEPARATELY)

None.

3.0 BMs TO BE INSTALLED

<u>FFBM</u>	<u>DESCRIPTION</u>	<u>SYSTEM/36 MODEL CHANGE</u>
21F4163	Tape high density feature upgrade	None

4.0 PREPARATION

- 4.1 Verify system operation by running SYSTEST (see Section 3 of MIM) before installing this feature.
- 4.2 Familiarize yourself with the purpose and details of this installation instruction.
- 4.3 Check all items and count parts listed on the BM to be installed to determine that all parts have been received.

Note: Prior to the handling of ESD-sensitive parts, refer to Appendix C of the 5363 MIM.

5.0 PROGRAM UPDATE

None.

6.0 PURPOSE AND DESCRIPTION

6.1 PURPOSE

Upgrade a System/5363 with 120 MB high density tape feature.

6.2 DESCRIPTION

Install tape drive, tape attach card, and signal cable between drive and card.

EC NO	837452A	837452B						
DATE	18OCT88	09DEC88						

7.0 INSTALLATION TIME

<u>FFBM</u>	<u>DESCRIPTION</u>	<u>MACH HRS</u>	<u>SYS HRS</u>	<u>NO OF CEs</u>
21F4163	High density tape feature upgrade	NA	NA	NA

8.0 SPECIAL TOOLS AND/OR MATERIAL REQUIRED

None.

INSTALLATION (Steps 9-11)

9.0 SAFETY

Remove all electrical power from the system and attached units before installation begins.

10.0 DETAILS OF INSTALLATION

- 10.1 REMOVE THE MACHINE REAR AND TOP COVERS (see MIM Procedure 305)
- 10.2 If low density tape drive is not installed, go to Step 10.3. Remove low density tape drive using MIM procedure 1010.
 - 10.2.1 Remove B1 Board Card Retainer and remove tape adapter logic card and cable from the system.
- 10.3 INSTALL TAPE ATTACH CARD (use Figure 1 for Steps 10.3.1 through 10.3.5)
 - 10.3.1 Remove B1 Board Card Retainer (if not removed during concurrent MES).
 - 10.3.2 Attach signal cable (PN 21F4128) to tape attach card furnished with this instruction. Note that the cable is keyed so it will attach to the card in only one way.
 - 10.3.3 Add one logic card guide, Part Number 92X3367, as shown in Figure 0.

Note: It may be necessary to remove the two inner square guides prior to installation.

EC NO	837452A	837452B					
DATE	18OCT88	09DEC88					

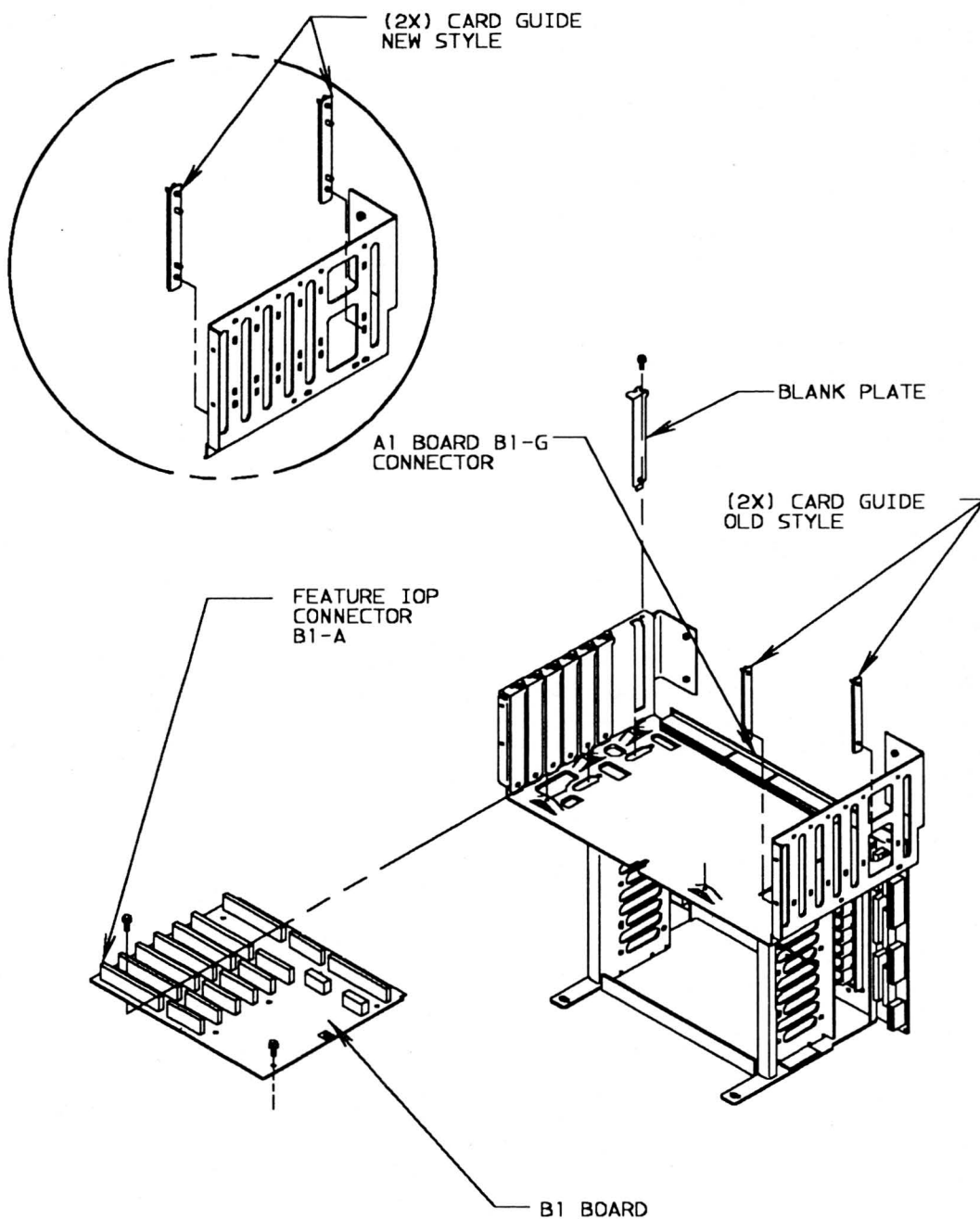

FIGURE 0

EC NO	837452A	837452B						
DATE	18OCT88	09DEC88						

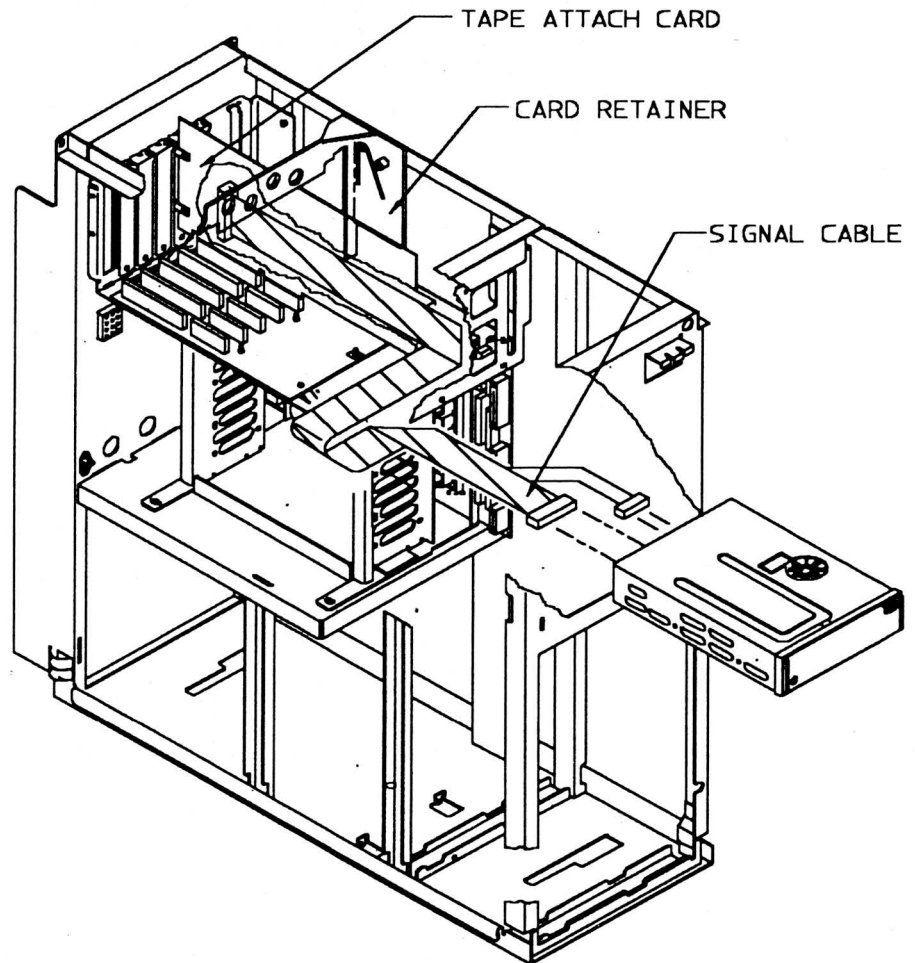

FIGURE 1

10.3.4 Remove Slot F access cover and insert tape attach card (any available slot on the B1 board may be used, but location B1-F is recommended). Card will function in any other slot if B1-F is occupied. Replace access cover screw to secure card to frame.

10.3.5 Route signal cable as shown in Figure 1. Cable folds as indicated.

10.4 INSTALL MOUNTING BRACKETS TO TAPE DRIVE

10.4.1 Attach the two bracket adapters to the tape drive with six screws (PN 1624743) (see Assembly 7)

EC NO	837452A	837452B						
DATE	18OCT88	09DEC88						

- 10.4.2 Attach mounting plate (Ref 3) to tape drive with four screws. Lay mounting plate (Ref 1) so that flange will slide under tabs, then slide plate to the rear until it snaps into place.

EC NO	837452A	837452B						
DATE	18OCT88	09DEC88						

ASSEMBLY 7: TAPE UNIT-BRACKET ASM, 120 MB

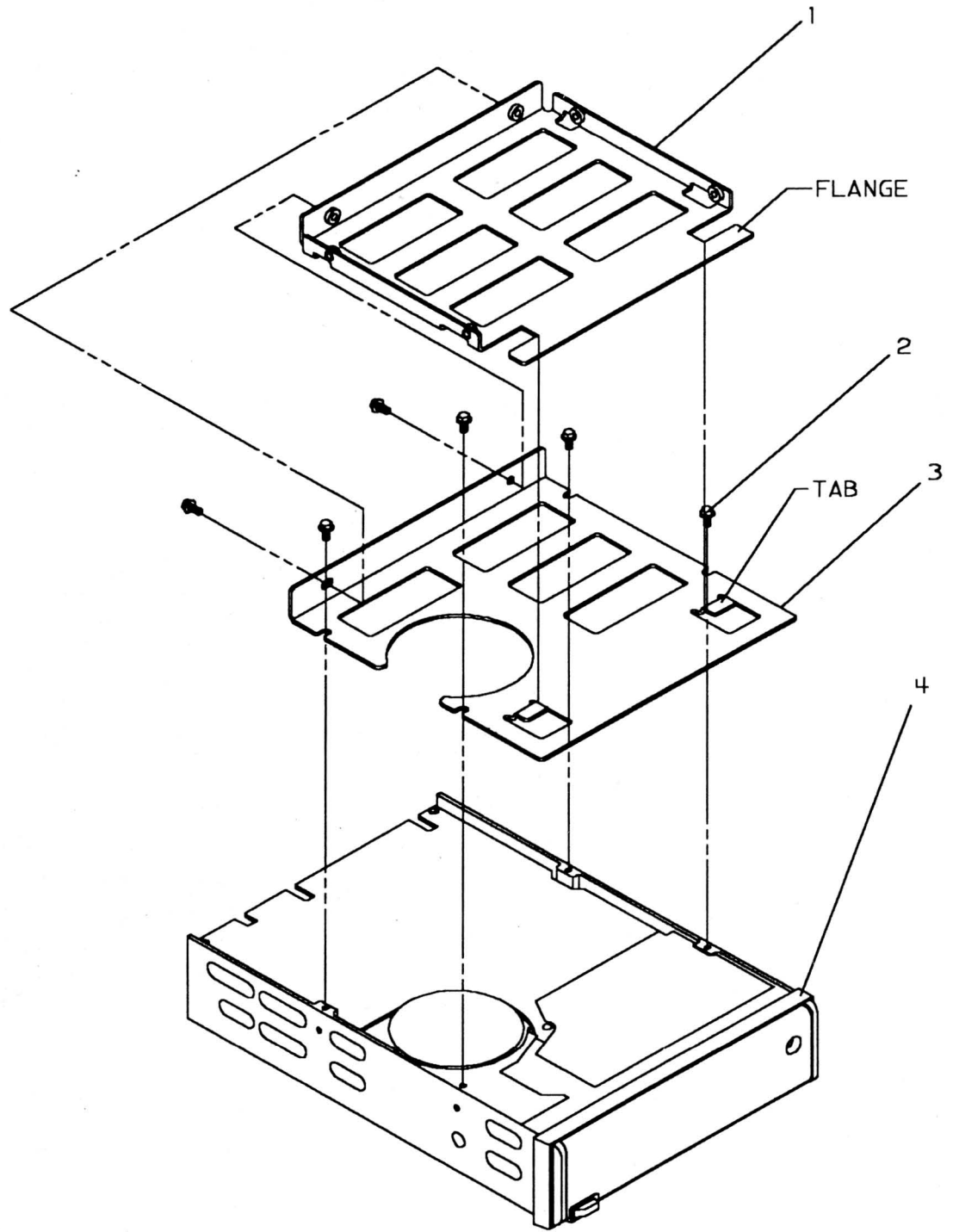

ASSEMBLY 7

EC NO	837452A	837452B							
DATE	18OCT88	09DEC88							

- 1 -1 Bracket Adapter
- 6 -2 Screw
- 1 -3 Bracket Adapter
- 1 -4 Tape Drive Unit, 120 MB
- 1 Tape Cable *Teague*
- 1 Tape Drive Bezel
- 1 Tape Attach Card
- 1 Card Guide
- 2** Finger Stock

10.5 INSTALL TAPE DRIVE (use Figure 2 for Steps 10.4.1 through 10.4.5)

- 10.5.1 Remove cover from tape slot opening if no tape drive is currently installed.
- 10.5.2 Partially insert the tape drive into the machine frame.

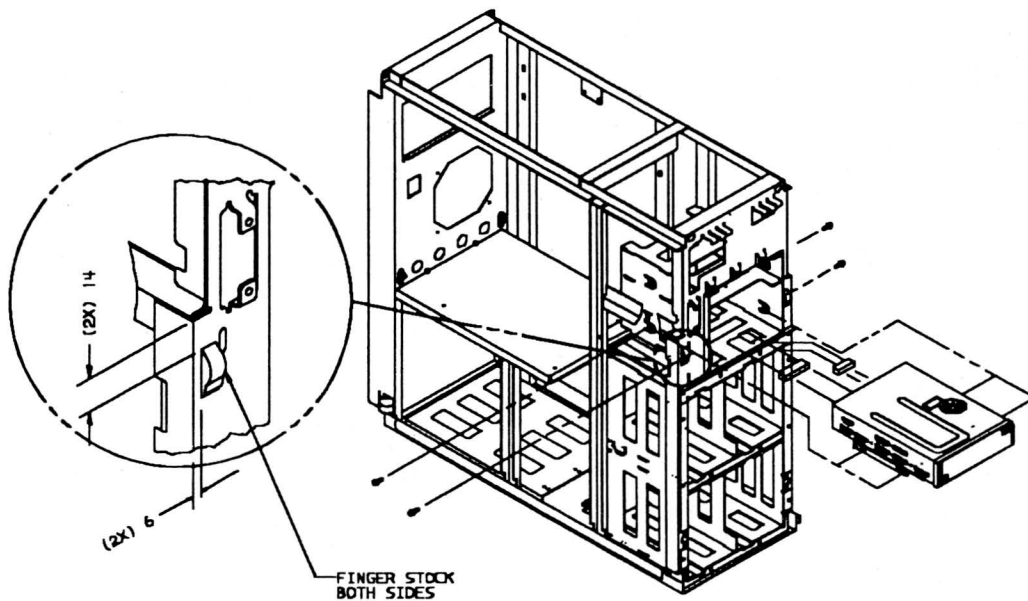

FIGURE 2

EC NO	837452A	837452B						
DATE	18OCT88	09DEC88						

- 10.5.3 Connect P11 power cable from the feature power supply, ground wire to ground tab, and the signal cable from the tape attach card. Note: Excess signal cable should reside in the B1-Board area.
- 10.5.4 Slide tape drive completely into frame.
- 10.5.5 Insert the four mounting screws with the 4-MM socket (PN 1624743, two on each side) into the tape drive support bracket. *Repair Man*
- 10.5.6 Place finger stock as shown in Figure 2 and press in place. If the frame already has finger stock, discard the parts that came with this FFBM.
- 10.5.7 Snap the bezel (PN 92X7499) into place.

EC NO	837452A	837452B						
DATE	18OCT88	09DEC88						

10.6 REPLACE COVERS

10.6.1 Before replacing covers, ensure that B1 Board card retainer is in place as shown in Figure 3.

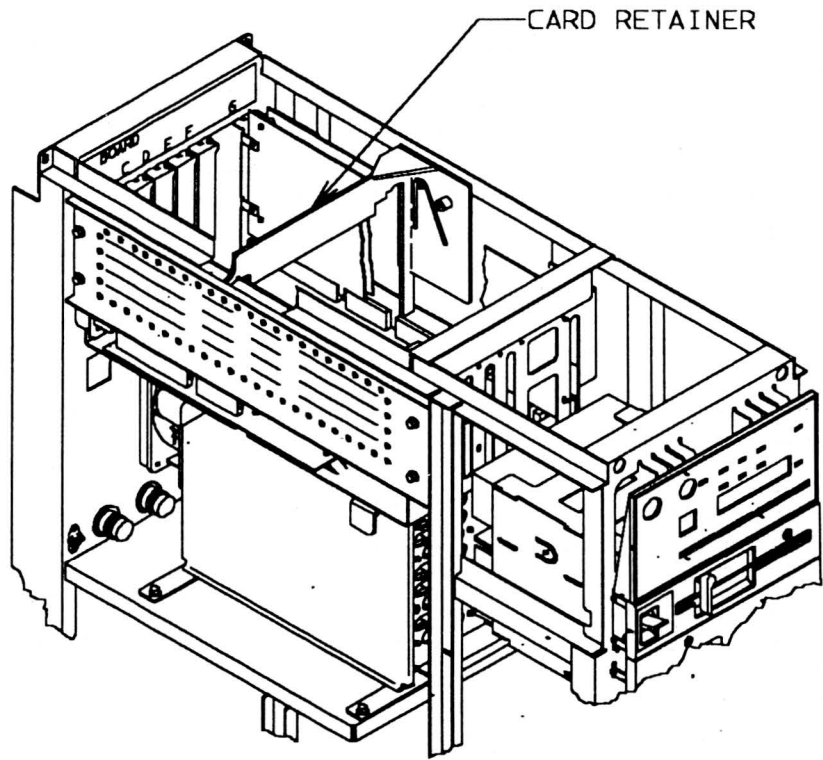

FIGURE 3

EC NO	837452A	837452B						
DATE	18OCT88	09DEC88						

11.0 TEST PROCEDURE

- 11.1 Plug power cord into wall outlet.
- 11.2 Set keylock to service position and power on the system.
- 11.3 IPL the new DSK61 diskette, PN 6374384, using Mode 3, 1000 option, to run customer autoconfigure/customize procedure (see Auto Configuring the System in General Procedures section of the MIM for reference).
Note: Use new Level DSK62, PN 6374385, when prompted.
- 11.4 Verify only those options that apply to devices installed.
- 11.5 Verify operation by running SYSTEST.

Note: Your system may contain either a 53 MB or a 120 MB internal streaming tape drive. Some manuals refer to either internal tape drive as the 6157. The 53 MB tape drive is read and write compatible, and provides interchange, with tapes used on the 6157 streaming tape drive attached to a System/36 including 5360, 5362, and 5364. The 120 MB tape drive is read only compatible with tapes written on the 6157. The 120 MB drive can read tapes written on a 6157, a 53 MB drive, or another 120 MB drive. Tapes written by a 120 MB drive cannot be read on a 6157 or 53 MB tape drive.

AFTER INSTALLATION (Steps 12-15)

12.0 FIELD UPDATES

None.

13.0 FIELD SUPPORT PUBLICATION

None.

14.0 PARTS DISPOSITION: DOMESTIC AND WT

- 14.1 Purchased machines
All removed parts are the property of the customer and should remain with the customer.
- 14.2 Documentation
Discard old DSK61 & 62.

15.0 MACHINE RECORDS

- 15.1 Report installation and quality according to existing procedures.

EC NO	837452A	837452B						
DATE	18OCT88	09DEC88						

DFS057I REQUESTED BLOCK NOT AVAILABLE: 0C7FDDDF4 RC=04

16DEC88 1120

PG-001

ORG LOC BLDG DEPT ADDRESSEE
D37 SAMP GDT. 0928 G.D.T.S.PALOMBA
FIELD ENGINEERING BILL-21F4163

EC LEVEL- 837474 LOC-VIME

MACHINE TYPE-5363-

TITLE- FFB/M

LUGE 125MB TAPE DRIVE

MAINTENANCE REFERENCE MATERIAL

CK PART NUMBER	QUANTITY	U/M	FRU	NAME	DESCRIPTION	REFERENCE/EC
21F4163	1	1		FFB/M	B/M COPY	
DFS057I REQUESTED BLOCK NOT AVAILABLE: 0C7FDDDF4 RC=04						
J 6374384	1	1		DISKETTE	DSKT 61 LUGE	
J 6374385	1	1		DISKETTE	DSKT 62 LUGE	
J 6374387	1	1		DISKETTE	LUGE 2675	

PARTS AND ASSEMBLIES

CK PART NUMBER	QUANTITY	U/M	FRU	NAME	DESCRIPTION	REFERENCE/EC
1624743	10	1		SCREW		
21F3125	1	1		LABEL		
21F4124	1	1		BRACKET	TAPE DRIVE	
21F4125	1	1		BRACKET	ADAPTOR	
21F4128	1	1		CABLE IDC	TAPE - 50 WIRE	
21F4210	2	1		SPRING		
92X3367	1	1		GUIDE	TAPE CARD	
92X4180	1	1		TAPE DRIVE	1/4" LUGE	
92X7223	1	1		HOLDER	VINYL DSMT HLD	
92X7470	1	1		INST INSTR	LUGE TAPE	837452B
92X7472	1	1		BDPOP	1.1 LUGE ADAPT	
DFS057I REQUESTED BLOCK NOT AVAILABLE: 0C7FDDDF4 RC=04						
92X7499	1	1		BEZEL	TAPE DRIVE	
93X0141	1	1		CASSETTE	1/4" CARTRIDGE	

COMMENTS- NONE

DFS057I REQUESTED BLOCK NOT AVAILABLE: 0C7FDDDF4 RC=04

16DEC88 1120

PG-002

ORG LOC BLDG DEPT ADDRESSEE
D37 SAMP GDT. 0928 G.D.T.S.PALOMBA
FIELD ENGINEERING BILL-21F4163

EC LEVEL- 837474 LOC-VIME

END OF BILL OF MATERIAL

DFS057I REQUESTED BLOCK NOT AVAILABLE: 0C7FDDDF4 RC=04

16DEC88 1120

PG-003

ORG LOC BLDG DEPT ADDRESSEE
D37 SAMP GDT. 0928 G.D.T.S.PALOMBA
FIELD ENGINEERING BILL-21F4163

EC LEVEL- 837474 LOC-VIME

THE FOLLOWING ITEMS IN BILL 21F4163 ARE J SOURCED OR J CHARACTER:

6374384, 6374385, 6374387,

THIS PAGE FOR LOCAL USE. DO NOT SEND TO THE FIELD.

DFS057I REQUESTED BLOCK NOT AVAILABLE: 0C7FDDDF4 RC=04

LAST PAGE